



SILVERSEA®

Be part of living history

ASIA 2025/2026



EXPLORE OUR DESTINATION VOYAGES

Use your smartphone camera to frame the QR Code (left) and tap the link that appears on the screen. You may need to download a QR reader app.

Come with us to uncover
the secrets of Asia,
one of the most intriguing regions
in the world. From iconic cities
to beautiful beaches, stunning
seafood and amazing wildlife,
there's something for every curious
traveller in this continent
of contrasts.

Table of contents

| | | | |
|---|----|-----------------------|----|
| 14 | | 34 | |
| <hr/> | | <hr/> | |
| A continent of contrasts | | Meet the fleet | |
| From iconic cities to beautiful beaches | 16 | <i>Silver Nova</i> | 38 |
| Immerse yourself in culture and cuisine | 18 | <i>Silver Moon</i> | 40 |
| Discover authentic Asia | 20 | <i>Silver Whisper</i> | 42 |
| S.A.L.T. Sea and Land Taste | 22 | | |
| Our Door-to-Door all-inclusive experience | 24 | | |
| 26 | | | |
| <hr/> | | | |
| Our voyages | | | |
| Grand Asia 2025 | | | |
| Spend longer, discover more | 28 | | |
| An unforgettable voyage around Japan | 30 | | |
| Uncover the wonders of South East Asia | 32 | | |







Junk boat
in Hong Kong harbour



Beef noodle soup in a
Chinese restaurant

Mount Fuji in spring, Japan









Floating market in
Damnoen Saduak near
Bangkok, Thailand



Imagine stepping into a world of constant contrasts, where every corner you see invites discovery – where all the kaleidoscopic sights, the symphony of sounds, and the alluring flavours wafting through the air all weave together to create a singular experience that transcends anything you have experienced before.

A continent of contrasts

Discover unparalleled scenery and unforgotten traditions as you dive deeper into the authentic beauty of Asia.

Welcome to Asia, where golden palaces overlook sapphire seas and time-worn temples sit alongside sky-scraping marvels of modern architecture. Asia doesn't just match up to your imagination, it exceeds it. Ancient arts are practised alongside restaurants run by robots, and you can ride the 100 mph bullet train to visit centuries-old castles.

Diverse natural and cultural experiences abound, from fragrant pale pink cherry blossom season in Japan to the UNESCO World Heritage sites of Gyeongju in Korea, where the morning sunlight first touches the Orient. One evening you could be watching

the floats at the Neputa festival displaying a kaleidoscope of colours. On the same voyage you can experience an exclusive authentic geisha performance rarely witnessed by visitors. And everywhere you travel, you'll embrace the exquisite flavours of Asia, from new culinary creations at world-class restaurants to an authentic Teppanyaki feast.

Like this diverse region, Silversea offers a superb choice of destinations, voyages and itineraries. So whether you want an epic adventure or a relaxing culinary and cultural tour, the best way to explore the world's most intriguing continue in unparalleled comfort is with Silversea.





Sea of Japan

Busan

Tokyo

Shanghai

East China Sea

Hong Kong

Bay of Bengal

Mumbai

South China Sea

Philippine Sea

Coron, Philippines

Phuket, Thailand

Ho Chi Minh City

Langkawi, Malaysia

Singapore

Banda Sea

Bali, Indonesia

Indian Ocean

From iconic cities to beautiful beaches

TOKYO

There's nowhere quite like Japan's kinetic capital, where 7th century temples nestle between soaring skyscrapers, bathed in the light of a thousand neon signs.

HIROSHIMA

Devastated by war and now a monument to peace, Hiroshima is a place of quiet contemplation with delicate pink cherry blossom covering the city in springtime.

FUKUOKA

Dive into hot springs, gourmet food and abundant natural and spiritual history on Kyushu Island. The capital Fukuoka is also the historical home of the Samurai.

HONG KONG

Ancient traditions blend seamlessly with modern life in a city where skyscrapers have holes to allow spirit dragons to soar from the hills to the harbour.

HO CHI MINH CITY

Ho Chi Minh City is an enchanting swirl of sensory stimulation, with incense-infused temples, colonial architecture, friendly people and delicious street food.

SINGAPORE

The "City of Gardens" is packed with gorgeous parks, the perfect place to watch as the futuristic skyscrapers put on a dazzling illuminated display after dark.

Immerse yourself in culture and cuisine

Uncover iconic cities and hidden gems that others sail by

Stay longer in must-see cities such as Tokyo, Hong Kong and Singapore. Uncover lesser-known wonders such as Beppu in Japan, home to more than 2,000 hot springs, or Nha Trang in Vietnam, famed for its white sandy beaches and restaurants serving the freshest seafood. With an unparalleled ratio of crew to guests, including our dedicated destination experts, a Silversea voyage allows you to fully immerse yourself in this enigmatic continent.

Take in the UNESCO Asia-Pacific Heritage award-winning Bao-An Temple in Keelung, then sample and savour true Taiwanese flavours at The Kitchen Restaurant while chatting to a local food expert. Experience a slice of local life in the Korean coastal city of Busan, including the Gamcheon

Cultural Village and bustling harbour-side market. Have a moment of reflection at the Hiroshima Memorial Park and Museum, or the sub-tropical island of Okinawa, site of the battle that marked the end of World War 2.

Whether you're boarding a bullet train or devouring a bao bun, a cultural and culinary adventure awaits you every day in Asia. The region is a feast for your senses, and Silversea lets you to indulge every one of them. So set sail for the East, in absolute comfort and luxury, and uncover the secrets of this diverse and mystical region.



A tailor-made kimono dress Green tea fields on Jeju Island,
South Korea



Discover authentic Asia

*Relax and reboot
in a region that
inspires everyone*

On a Silversea voyage you don't just visit Asia, you live it. One day you could be rocketing up a sky-scraping needle in an elevator to a viewing platform with panoramic views of the city and Tokyo Bay. The next you might be admiring the delicate patterns and exquisite embroidery of the traditional kimono, and maybe even trying one on for yourself.

We take you off the beaten path to discover hidden places that others simply sail by. Savour delicate flavours on a traditional tea farm in Jeju. Uncover the secrets of Bali and find out why locals call it the "Island of the Gods." Get a glimpse behind the enigmatic gaze of the geisha, and uncover the secrets of the samurai warriors who have served the Japanese Imperial Court since the 12th century.

Our expert guides will show you a side of Asia few others get to see. And since we believe that food offers a gateway into other cultures, your voyage also includes gastronomic adventures both on land and on board. Michelin-starred restaurants in Tokyo and Seoul. Amazing street food across the continent, including dishes you may never have tried from Korea, Vietnam and the Philippines. We go way beyond the traditional tourist fare to delve deeper into the soul of every destination. It's a newer and truer definition of travelling with taste.

S.A.L.T. Sea and Land Taste

*Discover a world
of flavour on board
and ashore*

Our unique culinary programme S.A.L.T. (Sea and Land Taste) is an innovative sensory journey designed to immerse you in the food, culture and stories of your destination. On your voyage to Asia you'll connect with local chefs, uncover traditional and contemporary techniques, and discover the secrets and stories behind the dishes they create, all in the

company of like-minded travellers. With menus that change in each place you visit, and space to recreate your favourite local dishes, S.A.L.T. brings the flavours of your destination right to your table.

*Exact features and events change with each itinerary. Please contact us for more information about your specific voyage.



S.A.L.T. Lab



S.A.L.T. LAB & CHEF'S TABLE

S.A.L.T. is all about discovering the soul of a place through its food and culture. Our intimate and interactive test kitchen features daily classes and tastings, led by our gourmet team and featuring a selection of exciting and innovative chefs and local experts. You'll enjoy a variety of culinary programmes, including creating your favourite regional dishes on board, for a deeper experience of the local cuisine wherever you visit.



S.A.L.T. KITCHEN

Our destination-focussed restaurant S.A.L.T. Kitchen takes you on a journey through food and wine, featuring menus designed and curated for your voyage by our chefs and local experts. Expect iconic specialities and innovative takes on traditional recipes, with different dishes and the finest local ingredients in each destination. It's the place to eat, wherever you are in the world.



S.A.L.T. BAR

Get a taste for the authentic at this unique venue serving drinks inspired by your destination. Order your favourite cocktail with a local twist, or try something excitingly new such as premium quality saké. Expert mixologists create custom-designed regional cocktails that change from port to port, using the best locally-sourced ingredients. So you can enjoy exclusive tastings with your fellow travellers, or just sit back and sip away.



S.A.L.T. EXPERIENCES

We offer expertly-crafted onshore experiences throughout your voyage. Understand the complex and compelling cuisine of Japan with a Michelin-starred chef, or join the gregarious "Fermentation Prince" Chef Nobuaki Fushiki for lunch. Other Asian highlights include eating at the multi-award-winning Intan Home Museum in Singapore, and a visit to the home of Michelin-starred chef Vichit Mukura for a plant-based cooking demonstration.

Our Door-to-Door all-inclusive experience

*Sail seamlessly
into the captivating
contrasts of Asia*

With Silversea, your journey is curated down to the smallest detail, for a seamless and effortless voyage, shore to shore and door to door. With almost one staff member for every guest, our service is unequalled, your every need anticipated and every wish fulfilled. Our Door-to-Door All-inclusive fare has it all, from international flights to transfers – including private executive

transfers from home to pre- and post-voyage hotel nights – to shore excursions in every port. Enjoy some of the most spacious and elegant accommodation at sea and an incredible selection of dining venues and beverages, all included as well.

*Exact features and events change with each itinerary, please contact us for more information about your specific voyage.



Enjoy the most personalised service at sea

| | |
|--|---|
| <i>Pre & post voyage benefits</i> | Private executive transfers (between home and airport) ¹ . |
| | International roundtrip flights. |
| | Business Class upgrades at reduced rates ² . |
| | Pre-cruise hotel night/s depending on Silversea's air programme flight schedule. |
| | Transfers between hotel, airport and ship. |
| | Luggage handling. |
| <i>Fine dining & beverages</i> | Multiple open-seated restaurants, serving diverse cuisine and an in-suite 24-hour dining service. |
| | Beverages in-suite and throughout the ship, including Champagne and selected wines, premium spirits, soft drinks, and more. |
| <i>Personalised service & amenities</i> | Butler service in every suite category. |
| | Industry leading crew-to-guest ratio. |
| | Onboard gratuities. |
| | Unlimited Wi-Fi. |
| <i>Excursions</i> | Shore excursions. |
| | Complimentary city centre shuttle when applicable. |

Door-to-door fare not available in some countries in Europe, Asia and Latin America. While Silversea strives to serve guests all listed items included as part of our Door-to-Door all-inclusive package, some items may be excluded in certain destinations or countries. Find detailed information on www.silversea.com/terms-and-conditions. | ¹ Applicable for distances of up to 50 miles (80 km). For longer distances, special tariffs apply. | ² Business Class upgrades are available in selected destinations.

Our voyages



Golden Bridge in Da Nang,
Vietnam



Grand Asia 2025

Spend longer, discover more

SINGAPORE TO SINGAPORE

Silver Whisper

15 Feb 25 - Duration 70 Days

Step on board *Silver Whisper* for a Grand Voyage across the Far East, taking in all the culture, cuisine, history and natural beauty of Asia. Spend longer in spectacular cities such as Singapore, Shanghai and Tokyo. Relax on the blissful beaches of Koh Samui in Thailand, or unwind with a traditional

hot spa treatment in Nha Trang, Vietnam. This 70-day adventure takes you to nine countries and includes a 14-day circumnavigation of Japan during 'Sakura' or cherry blossom season, where every tree is a mass of fragrant pink petals.

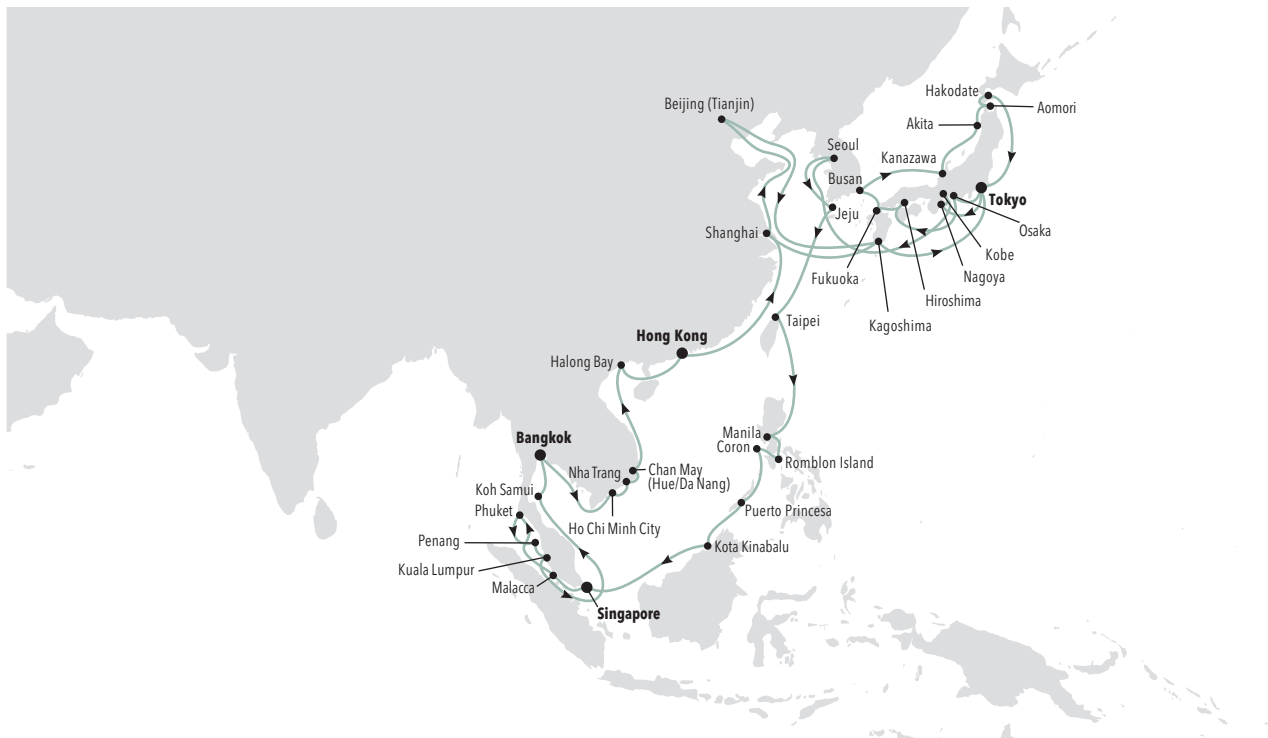



An unforgettable voyage around Japan

*Dive deeper into
the land of
tradition and taste*

This epic voyage is a feast for all your senses. Stay overnight in Osaka, the street food capital of Japan. See traditional lanterns twinkling in the night sky in Busan, South Korea. Take time to reflect at the Peace Memorial in Hiroshima. Your 14-day voyage includes relaxing days at

sea, where you'll also discover a world of indulgences on board *Silver Nova*. And it starts and ends in Japan's kinetic capital Tokyo, with plenty of time to visit 7th century temples, tranquil palaces and restaurants serving the freshest sushi.



Nishi park in Fukuoka, Kyushu, Japan

SAMPLE ITINERARY

TOKYO
TO TOKYO

Duration 14 Days

Silver Nova



| DAY BY DAY | | | |
|------------|-------------------------|--------|--------|
| DAYS | | ARRIVE | DEPART |
| 1 | TOKYO | | 19:00 |
| 2 | DAY AT SEA | | |
| 3 | OSAKA | 08:00 | |
| 4 | OSAKA | | 23:00 |
| 5 | DAY AT SEA | | |
| 6 | HIROSHIMA | 07:00 | 17:00 |
| 7 | KANMON STRAIT PASSAGE | | |
| 7 | FUKUOKA (KYUSHU ISLAND) | 09:00 | 19:00 |
| 8 | BUSAN | 07:00 | 23:00 |
| 9 | DAY AT SEA | | |
| 10 | KANAZAWA | 07:00 | 23:00 |
| 11 | DAY AT SEA | | |
| 12 | AOMORI | 08:00 | 18:00 |
| 13 | HAKODATE (HOKKAIDO) | 08:00 | 17:00 |
| 14 | DAY AT SEA | | |
| 15 | TOKYO | 07:00 | |

SAILING MONTHS*:

MAR

*Itineraries may vary for other departures.



Subregion highlights:

- Japan's capital is a dazzling sensory overload, where ancient temples nestle between sky-scraping marvels of modern architecture and the food and drink delights range from traditional teahouses and must-try street food to Michelin-starred restaurants.
- Allow yourself a moment of quiet contemplation as you walk down the leafy boulevards of Peace Memorial Park in Hiroshima, a UNESCO World Heritage Site. You'll also find inspiring message of hope all around the city.
- Enjoy an overnight stay in Osaka, where giant octopuses cling to buildings and bustling restaurants pack in the crowds. This is Japan at its most fun, friendly and flavourful.
- Fukuoka, capital of Kyushu Island, is known as the traditional home of the samurai, Japan's ancient warrior class. The island is also home to hot springs and gourmet food, as well as abundant natural and spiritual history.
- If you love seafood, you'll love Hakodate on the southern tip of Hokkaido. Try the world-famous squid sashimi, caught fresh in the icy cold waters that surround the island.

Uncover the wonders of South East Asia

10 destinations
5 countries
A world of adventures

Join us on an epic voyage to explore the highlights of South East Asia. Travelling from Japan's kinetic capital to the city-state of Singapore, you can dive deeper into the history and mystery, culture and cuisine of this magical region, including an over-night in stay in Hong Kong, one

of the world's most intriguing cities. From traditional temples to stunning sky-scrapers, mouth-watering street food to Michelin-starred restaurants, with Silversea you'll see, taste and try something new in every place you visit.



Singapore business district

**TOKYO
TO SINGAPORE**

Duration **16 Days**

Silver Moon



| DAY BY DAY | | | |
|------------|------------------------|--------|--------|
| DAYS | | ARRIVE | DEPART |
| 1 | TOKYO | | 19:00 |
| 2 | NAGOYA | 12:00 | 18:00 |
| 3 | KOCHI | 12:00 | 19:00 |
| 4 | BEPPU (KYUSHU ISLAND) | 08:00 | 18:00 |
| 5 | KANMON STRAITS PASSAGE | 03:00 | 05:00 |
| 5 | DAY AT SEA | 05:30 | 06:00 |
| 6 | JEJU | 07:00 | 18:00 |
| 7 | DAY AT SEA | | |
| 8 | KEELUNG, TAIWAN | 08:00 | 18:00 |
| 9 | DAY AT SEA | | |
| 10 | HONG KONG | 08:00 | |
| 11 | HONG KONG | | 16:00 |
| 12 | DAY AT SEA | | |
| 13 | NHA TRANG | 12:00 | 22:00 |
| 14 | DAY AT SEA | | |
| 15 | DAY AT SEA | | |
| 16 | SINGAPORE | 08:00 | |

Itineraries may vary for other departures.



Subregion highlights:

- Ancient traditions and futuristic buildings. Lantern-decorated temples and vibrant neon signs. Traditional teahouses and cutting-edge cuisine. Discover Tokyo, city of contrasts.
- Leave the traditional tourist trail behind to find multiple museums, time-worn temples and amazing shopping in Nagoya.
- Beppu is pretty as a picture, with lantern-lit hot springs, cherry trees and rhododendrons, and stone Buddhas carved into the top of Mount Tsurumi.
- Clear blue waters meet stunning black, white and red sand beaches on Jeju, South Korea. The island is also a culinary paradise of local specialities.
- Keelung may be the gateway to Taipei's glittering lights, but don't miss the Miaokou night market, a salivating sensation for your tastebuds.
- Hong Kong is where vibrant modern metropolis meets centuries-old temples, and the waterfront's buildings put on a Symphony of Light every evening.
- Emerald hills overlook white sandy beaches in the Vietnamese city of Nha Trang, and boho beach life is balanced with historical heritage.
- Outdoor spaces abound in Singapore "City of Gardens," and the cuisine is a fabulous fusion of Indian, Chinese, Indonesian and Malay influences.

Meet the fleet

*Welcome on board
Silver Nova
and Silver Moon*

The innovative asymmetrical design of our flagship *Silver Nova* brings guests closer to every destination, with wide-open vistas including new aft suites that deliver stunning 270° views. All the Silversea hallmarks are taken to the next level with outstanding gastronomy, signature Otium wellness treatments, butler service in every suite and

an unparalleled crew-to-guest ratio. Sister ship to our ever-popular *Silver Muse*, *Silver Moon* combines small-ship intimacy with spacious all-suite accommodation. *Silver Moon*'s dining options include Silversea's unique S.A.L.T. programme, guiding guests through immersive destination-based gastronomic experiences.



SILVER NOVA

544 Crew / 728 Guests
Built 2023



SILVER MOON

411 Crew / 596 Guests
Built 2020



SILVER WHISPER

302 Crew / 388 Guests
Refurbished 2018

Silver Nova's maiden voyage *The Atrium on Silver Nova*

*Dinner at The Marquee,
Silver Nova*



The Marquee, *Silver Nova* La Dolce Vita restaurant on
Silver Nova





Silver Nova

SHIP SPECIFICATIONS

| | |
|----------|---------------------|
| Crew | 556 |
| Officers | International |
| Guests | 728 |
| Tonnage | 54,700 |
| Length | 801 Feet / 244.2 Mt |
| Width | 97 Feet / 29.6 Mt |
| Speed | 19.4 Knots |
| Built | 2023 |



DECK 11

The Cliff Whirlpool
Sun Deck

DECK 10

Observation Lounge
S.A.L.T. Lab
S.A.L.T. Bar
Pool Deck
Pool Bar
The Marquee
The Dusk Bar
Jogging Track

DECK 09, 08, 07, 06

Suites

DECK 05

Otium Spa
Fitness Centre
Beauty Salon
Casino
Boutique
Dolce Vita
Silver Note
Connoisseur's Corner
Panorama Lounge

DECK 04

La Dame
Venetian Lounge
Boutique
Reception
Arts Café
Shore Concierge
Atrium
Kaiseki
La Terrazza

DECK 03

The Shelter
Atlantide
S.A.L.T. Kitchen

SUITE CATEGORIES

Otium Suite
Owner's Suite
Grand Suite
Master Suite
Signature Suite
Silver Suite
Junior Grand Suite
Premium Medallion Suite
Medallion Suite
Premium Veranda Suite
Deluxe Veranda Suite
Superior Veranda Suite
Classic Veranda Suite



11

10

09

08

07

06

05

04

03

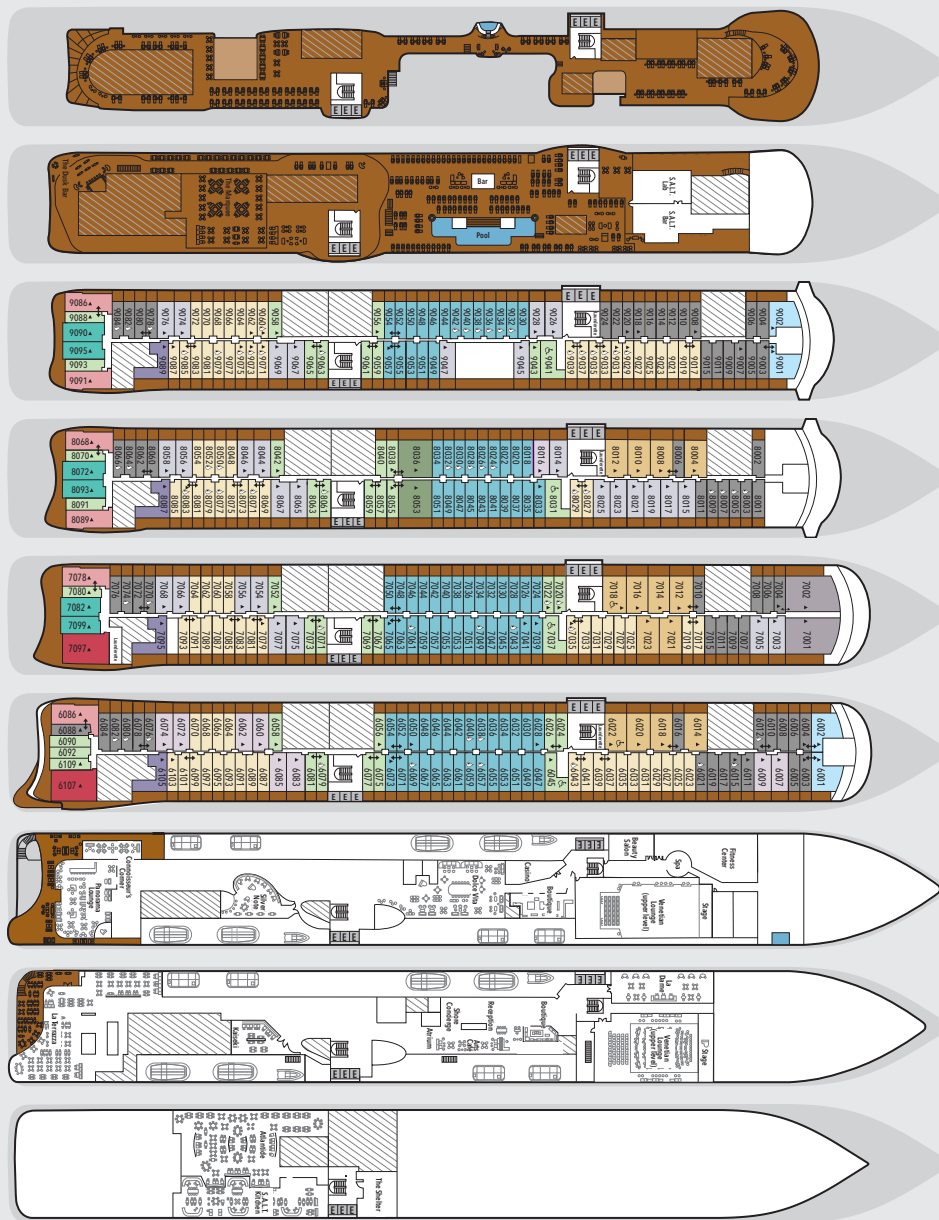



OTIUM SUITE

1324 SQ.FT. / 123 M²
INCLUDING VERANDA (431 SQ.FT. / 40 M²)

- Large veranda with patio furniture and floor-to-ceiling glass doors and private hot tub
- Living room with convertible sofa to accommodate an additional guest
- Separate dining area
- Bathroom with double faucets on large vanity, separate shower and whirlpool bath
- Twin beds or king-sized bed;
- Walk-in wardrobe(s) with personal safe
- Two large flat-screen TVs
- Sound system and espresso machine



OWNER'S SUITE

1 BEDROOM: 1055 SQ.FT. / 98 M² INCLUDING VERANDA (172 SQ.FT. / 16 M²)
2 BEDROOM: 1412 SQ.FT. / 131 M² INCLUDING VERANDA (228 SQ.FT. / 21 M²)

- Large veranda with patio furniture and floor-to-ceiling glass doors; bedroom two has additional veranda
- Living room with convertible sofa to accommodate an additional guest; bedroom two has additional sitting area
- Separate dining area
- Bathroom with double faucets on large vanity, shower and whirlpool bath; bedroom two has additional bathroom with shower
- Twin beds or king-sized bed; bedroom two has twin beds or queen-sized bed
- Walk-in wardrobe(s) with personal safe
- Two large flat-screen TVs, plus two additional flat-screen TV
- Sound system and espresso machine



GRAND SUITE

1 BEDROOM: 915 SQ.FT. / 85 M² INCLUDING VERANDA (140 SQ.FT. / 13 M²)
2 BEDROOM: 1270 SQ.FT. / 118 M² INCLUDING VERANDA (194 SQ.FT. / 18 M²)

- Large veranda with patio furniture and floor-to-ceiling glass doors; bedroom two has additional veranda
- Living room with convertible sofa to accommodate an additional guest; bedroom two has additional sitting area
- Separate dining area
- Bathroom with double faucets on large vanity, separate shower and whirlpool bathtub; bedroom two has additional bathroom with bathtub or shower
- Twin beds or king-sized bed; bedroom two features twin beds or queen-sized bed
- Walk-in wardrobe(s) with personal safe
- Two large flat-screen TVs
- Sound system and espresso machine



MASTER SUITE

1 BEDROOM: 721-826 SQ.FT. / 67-77 M² INCLUDING VERANDA (233-330 SQ.FT. / 22-31 M²)
2 BEDROOM: 1078-1183 SQ.FT. / 100-110 M² INCLUDING VERANDA (286-383 SQ.FT. / 27-36 M²)

- Large Veranda with patio furniture and floor-to-ceiling glass doors; bedroom two has additional veranda
- Living room with convertible sofa to accommodate an additional guest; bedroom two features sitting area
- Bathroom with double faucets on large vanity, shower and whirlpool bath; bedroom two features bathroom with shower or bath
- Twin beds or queen-sized bed; bedroom two has additional twin beds or queen-sized bed
- Walk-in wardrobe(s) with personal safe
- Two large flat-screen TVs
- Sound system and espresso machine



SIGNATURE SUITE

700 SQ.FT. / 65 M²
INCLUDING VERANDA (172 SQ.FT. / 16 M²)

- Large veranda with patio furniture and floor-to-ceiling glass doors
- Living room with convertible sofa to accommodate an additional guest
- Separate dining area
- Bathroom with double faucets on large vanity, shower and whirlpool bath
- Twin beds or queen-sized bed
- Walk-in wardrobe(s) with personal safe
- Two large flat-screen TVs
- Sound system and espresso machine



SILVER SUITE

1 BEDROOM: 678 SQ.FT. / 63 M² INCLUDING VERANDA (118 SQ.FT. / 11 M²)
2 BEDROOM: 1033 SQ.FT. / 96 M² INCLUDING VERANDA (172 SQ.FT. / 16 M²)

- Large veranda with patio furniture and floor-to-ceiling glass doors
- Living room with convertible sofa to accommodate an additional guest; bedroom two has additional sitting area
- Separate dining area
- Bathroom* with double faucets on large vanity, shower and whirlpool bath; bedroom two has additional bathroom with shower or bath
- Twin beds or king-sized bed; bedroom two has additional twin beds or queen-sized bed
- Walk-in wardrobe(s) with personal safe
- Two large flat-screen TVs
- Sound system and espresso machine



JUNIOR GRAND SUITE

1 BEDROOM: 581-624 SQ.FT. / 54-58 M² INCLUDING VERANDA (65 SQ.FT. / 6 M²)
2 BEDROOM: 936-980 SQ.FT. / 87-91 M² INCLUDING VERANDA (118 SQ.FT. / 11 M²)

- Veranda with patio furniture and floor-to-ceiling glass doors; bedroom two has additional veranda
- Living room with convertible sofa accommodate an additional guest; bedroom two has additional sitting area
- Bathroom with double faucets on large vanity, shower and whirlpool bath; bedroom two has additional bathroom with shower
- Twin beds or queen-sized bed; bedroom two has twin beds or queen-sized bed
- Walk-in wardrobe(s) with personal safe
- Two large flat-screen TVs in bedroom two
- Sound system and espresso machine



PREMIUM MEDALLION SUITE / MEDALLION SUITE

527 SQ.FT. / 49 M²
INCLUDING VERANDA (86 SQ.FT. / 8 M²)

- Veranda with patio furniture and floor-to-ceiling glass doors
- Living room with convertible sofa to accommodate an additional guest
- Bathroom with double faucets on large vanity, separate shower and bathtub
- Twin beds or queen-sized bed; bedroom two has additional twin beds or queen sized bed
- Walk-in wardrobe with personal safe
- Two large flat-screen TVs
- Sound system and espresso machine



PREMIUM VERANDA/DELUXE VERANDA/SUPERIOR VERANDA/CLASSIC VERANDA

357 SQ.FT. / 33 M² INCLUDING VERANDA (53 SQ.FT. / 5 M²)

- Veranda with patio furniture and floor-to-ceiling glass doors
- Sitting area
- Twin beds or queen-sized bed
- Bathroom with double faucets on large vanity, separate shower or full-sized bath and separate shower
- Walk-in wardrobe with personal safe
- One large flat-screen TV

AMENITIES & FEATURES FOR ALL SUITES

- Refrigerator and bar setup stocked with your preferences
- Plush bathrobes
- Pillow menu
- Complimentary Wi-Fi
- Umbrella
- Hair dryer
- Direct-dial telephone(s)
- Interactive Media Library
- Vanity table
- Writing desk
- Custom-made luxury bed mattresses

Suite diagrams are for illustration purposes only. Features, materials, finishes and layout may be different than shown and subject to change.

Silver Moon

SHIP SPECIFICATIONS

| | |
|----------|-------------------|
| Crew | 411 |
| Officers | International |
| Guests | 596 |
| Tonnage | 40,700 |
| Length | 698 Feet/212.8 Mt |
| Width | 86 Feet/27 Mt |
| Speed | 19.8 Knots |
| Built | 2020 |

DECK 11

Observation Library
Spaccanapoli
Jogging Track

DECK 10

Pool Deck
Pool Bar
The Grill
Whirlpool Area

DECK 09

Panorama Lounge
Connoisseur's Corner

DECK 08

Arts Café
Boutique
La Dame

DECK 07

La Terrazza
Silver Note
Casino

DECK 06

Beauty Spa
Fitness Centre

DECK 05

Reception/Guest Relations
Shore Concierge
Dolce Vita
Venetian Lounge
Future Cruise Sales

DECK 04

Atlantide
Kaiseiki
S.A.L.T. Kitchen
S.A.L.T. Bar
S.A.L.T. Lab

SUITE CATEGORIES

Owner's Suite
Grand Suite
Royal Suite
Silver Suite
Deluxe Veranda Suite
Superior Veranda Suite
Classic Veranda Suite
Panorama Suite
Vista Suite

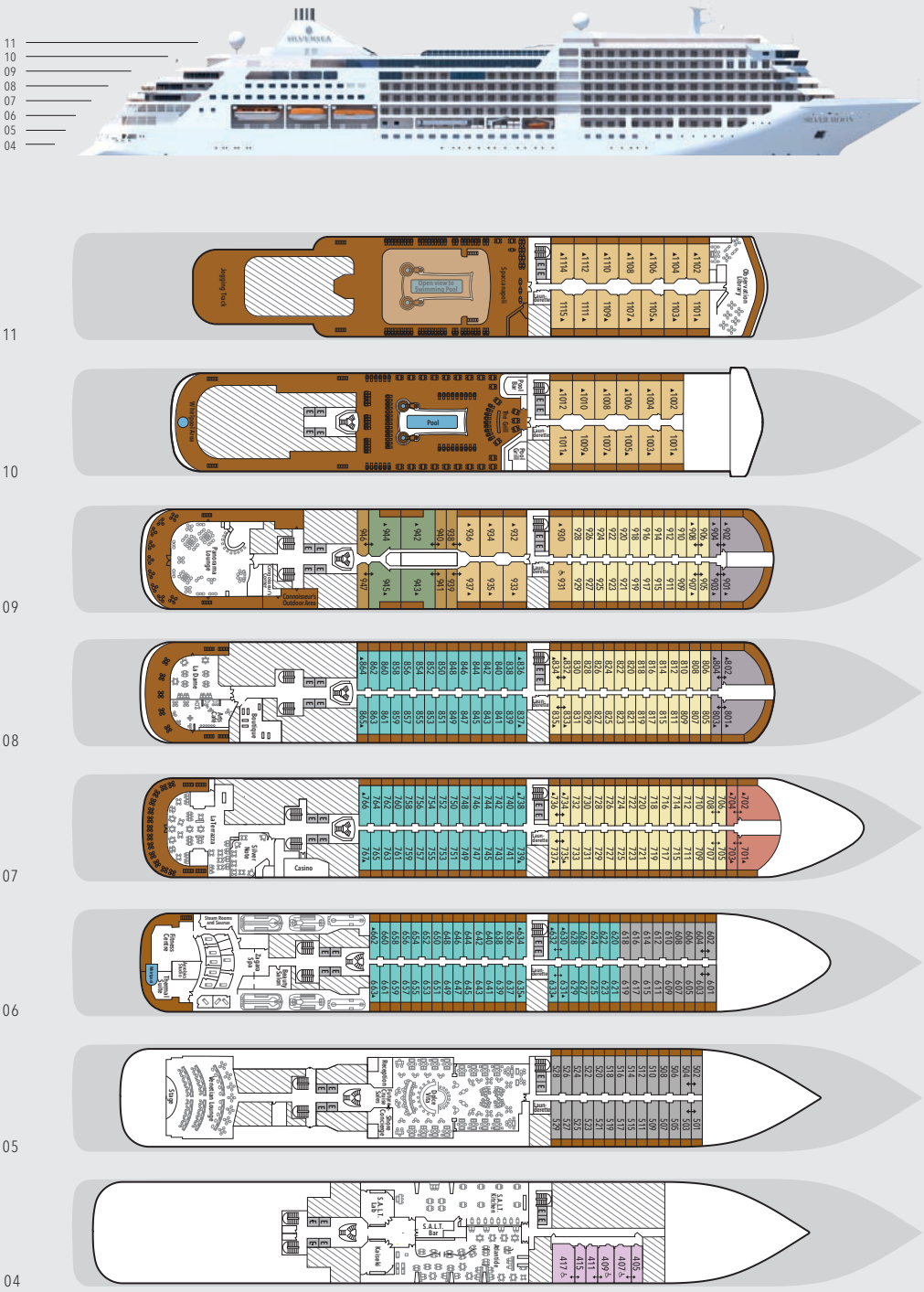

Deck plans are for illustration purposes only and may be subject to change.



OWNER'S SUITE

Available as a one-bedroom configuration or as a two-bedroom by adjoining with a Panorama suite (as illustrated)

1 BEDROOM: 947-1055 SQ FT / 88-98 M²
INCLUDING VERANDA (129 SQ FT / 12 M²)
2 BEDROOM: 1281-1389 SQ FT / 119-129 M²
INCLUDING VERANDA (129 SQ FT / 12 M²)

- Large veranda with patio furniture and floor-to-ceiling glass doors; bedroom two has additional large picture window
- Living room with sitting area; bedroom two has additional sitting area
- Separate dining area
- Twin beds or king-sized bed; bedroom two has additional twin beds or queen-sized bed
- Bathroom with double vanity, separate shower and full-sized bath, plus a powder room; bedroom two has additional bathroom with shower
- Custom-made luxury bed mattresses
- Walk-in wardrobe(s) with personal safe
- Vanity table(s)
- Writing desk(s)
- One 55" / 140 cm and one 40" / 102 cm flat-screen HD TV in main suite, plus one 40" / 102 cm flat-screen HD TV in bedroom two
- Interactive Media Library
- Sound system with Bluetooth connectivity
- Espresso machine
- Unlimited Premium Wi-Fi



GRAND SUITE

Available as a one-bedroom configuration or as a two-bedroom by adjoining with a Veranda Suite (as illustrated).

DECK 8: 1 BEDROOM: 1572 SQ FT / 146 M²
INCLUDING VERANDA: (570 SQ FT / 53 M²)
2 BEDROOM: 1970 SQ FT / 183 M²
INCLUDING VERANDA: (635 SQ FT / 59 M²)
DECK 9: 1 BEDROOM: 1472 SQ FT / 137 M²
INCLUDING VERANDA: (474 SQ FT / 44 M²)
2 BEDROOM: 1873 SQ FT / 174 M²
INCLUDING VERANDA: (538 SQ FT / 50 M²)

- Two verandas with patio furniture and floor-to-ceiling glass doors; bedroom two has additional veranda
- Living room with convertible sofa to accommodate an additional guest
- Sitting area; bedroom two has additional sitting area
- Separate dining area
- Twin beds or king-sized bed; bedroom two has additional twin beds or queen-sized bed
- Bathroom with double vanity, separate shower and full-sized bath, plus a powder room; bedroom two has additional bathroom with full-sized bath
- Custom-made luxury bed mattresses
- Walk-in wardrobe(s) with personal safe
- Vanity table(s)
- Writing desk(s)
- One 55" / 140 cm and one 40" / 102 cm flat-screen HD TV in main suite, plus one 40" / 102 cm flat-screen HD TV in bedroom two
- Interactive Media Library
- Sound system with Bluetooth connectivity
- Espresso machine
- Unlimited Premium Wi-Fi



ROYAL SUITE

Available as a one-bedroom configuration or as a two-bedroom by adjoining with a Veranda suite (as illustrated)

1 BEDROOM: 1130 SQ FT / 105 M²
INCLUDING VERANDA (129 SQ FT / 12 M²)
2 BEDROOM: 1528 SQ FT / 142 M²
INCLUDING VERANDA (194 SQ FT / 18 M²)

- Large veranda with patio furniture and floor-to-ceiling glass doors; bedroom two has additional veranda
- Living room with convertible sofa to accommodate an additional guest
- Sitting area; bedroom two has additional sitting area
- Separate dining area
- Twin beds or king-sized bed; bedroom two has additional twin beds or queen-sized bed
- Bathroom with double vanity, separate shower and full-sized bath, plus a powder room; bedroom two has additional bathroom with full-sized bath
- Custom-made luxury bed mattresses
- Walk-in wardrobe(s) with personal safe
- Vanity table(s)
- Writing desk(s)
- One 55" / 140 cm and one 40" / 102 cm flat-screen HD TV in main suite, plus one 40" / 102 cm flat-screen HD TV in bedroom two
- Interactive Media Library
- Sound system with Bluetooth connectivity
- Espresso machine
- Unlimited Premium Wi-Fi



SILVER SUITE

Available as a one-bedroom configuration or as a two-bedroom by adjoining with a Panorama suite. One suite available as a wheelchair accessible suite.

1 BEDROOM: 786 SQ FT / 73 M²
INCLUDING VERANDA (129 SQ FT / 12 M²)
2 BEDROOM: 1119 SQ FT / 104 M²
INCLUDING VERANDA (129 SQ FT / 12 M²)

- Veranda with patio furniture and floor-to-ceiling glass doors
- Living room with convertible sofa to accommodate an additional guest
- Sitting area
- Separate dining area
- Twin beds or king-sized bed
- Bathroom with double vanity, full-sized bath, separate shower; bedroom two has additional bathroom with full-sized bath
- Wheelchair accessible suite has a bathroom with vanity and separate shower (no full-sized bath as illustrated)
- Walk-in wardrobe with personal safe
- Vanity table
- Writing desk
- One 55" / 140 cm and one 40" / 102 cm flat-screen HD TV in main suite; plus one 40" / 102 cm flat-screen HD TV in bedroom two
- Interactive Media Library
- Sound system with Bluetooth connectivity
- Espresso machine
- Unlimited Premium Wi-Fi



DELUXE VERANDA SUITE SUPERIOR VERANDA SUITE CLASSIC VERANDA SUITE

Some Veranda Suites accommodate three guests. Deluxe Verandas offer preferred central location with identical accommodations to Classic and Superior Verandas.

387 SQ FT / 36 M²
INCLUDING VERANDA (64 SQ FT / 6 M²)

- Veranda with patio furniture and floor-to-ceiling glass doors
- Sitting area
- Twin beds or queen-sized bed
- Bathroom with vanity, full-sized bath, separate shower
- Walk-in wardrobe with personal safe
- Writing desk
- One 40" / 102 cm flat-screen HD TV
- Interactive Media Library
- Unlimited Standard Wi-Fi



PANORAMA SUITE

Available as a one-bedroom configuration.

DECK 9: 334 SQ FT / 31 M²

- Sitting area
- Twin beds or queen-sized bed
- Bathroom with vanity, full-sized bath, separate shower
- Walk-in wardrobe with personal safe
- Writing desk
- One 40" / 102 cm flat-screen HD TV
- Interactive Media Library
- Unlimited Standard Wi-Fi



VISTA SUITE

Some Vista Suites are available as a wheelchair accessible suite.*

DECK 4: 334 SQ FT / 31 M²
WHEELCHAIR ACCESSIBLE SUITE: 440-646 SQ FT / 41-60 M²

- Sitting area
- Twin beds or queen-sized bed
- Bathroom with vanity, full-sized bath, separate shower
- Wheelchair accessible suite has a bathroom with vanity and separate shower (no full-sized bath)
- Walk-in wardrobe with personal safe; wheelchair accessible suites fitted with cupboards and wardrobe with personal safe
- Writing desk
- One 40" / 102 cm flat-screen HD TV
- Interactive Media Library
- Unlimited Standard Wi-Fi

*Wheelchair accessible suite does not include full-sized bath

AMENITIES & FEATURES FOR ALL SUITES

- Butler service
- Refrigerator and bar setup stocked with your preferences
- Plush bathrobes
- Pillow menu
- Luxury bath amenities
- Complimentary Wi-Fi for all suites
- Umbrella
- Hair dryer
- Wall mounted USB-C mobile device chargers
- Direct-dial telephone(s)
- Champagne on arrival

Suite diagrams shown are for illustration purposes only and may vary from actual square footage. Please refer to suite specifications for square footage.

Silver Whisper

SHIP SPECIFICATIONS

| | |
|-------------|-------------------|
| Crew | 302 |
| Officers | International |
| Guests | 388 |
| Tonnage | 28,258 |
| Length | 610 Feet/186 Mt |
| Width | 81.8 Feet/24.9 Mt |
| Speed | 18.5 Knots |
| Refurbished | 2018 |



DECK 10
Fitness Centre
Zagara Beauty Spa
Observation Library



DECK 09
Jogging Track

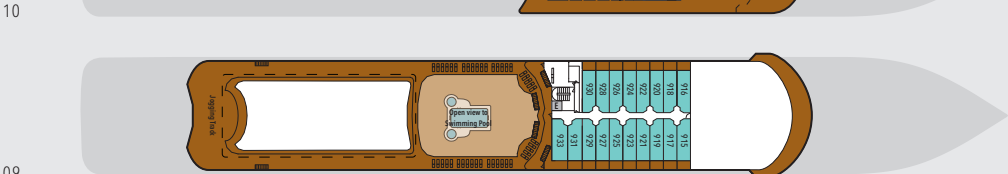

DECK 08
Pool Deck
Pool Bar
The Grill
Connoisseur's Corner
Casino
Panorama Lounge

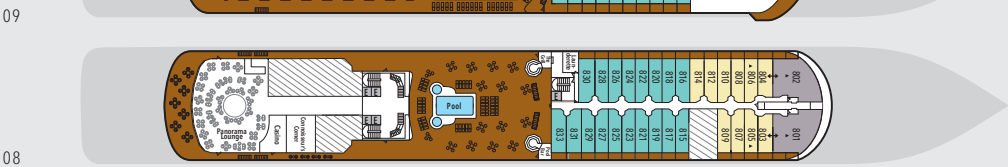

DECK 07
La Terrazza
La Dame
Conference/Card Room



DECK 06
The Show Lounge

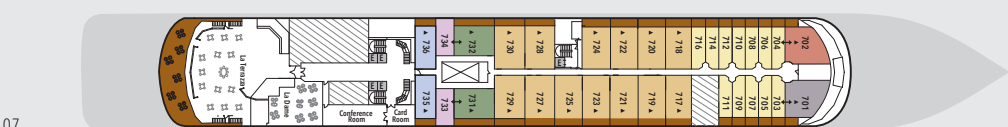

DECK 05
Boutiques
Atrium
Future Cruise Sales
Reception/Guest Relations
Shore Concierge
Future Cruise Sales
The Bar

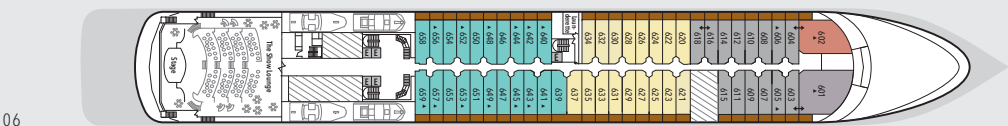

DECK 04
The Restaurant

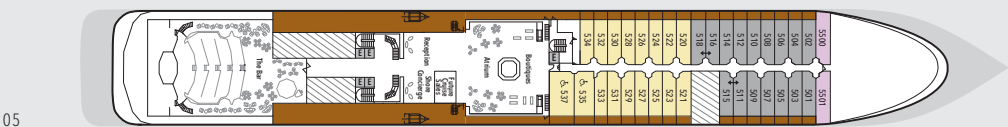

SUITE CATEGORIES

- Owner's Suite
- Grand Suite
- Royal Suite
- Silver Suite
- Medallion Suite
- Deluxe Veranda Suite
- Superior Veranda Suite
- Classic Veranda Suite
- Vista Suite

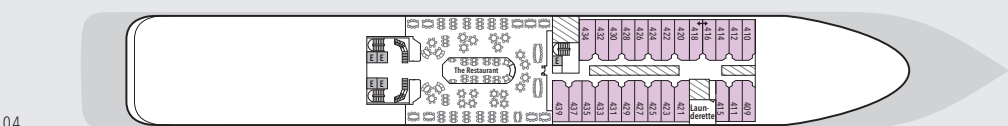

Deck plans are for illustration purposes only and may be subject to change.



OWNER'S SUITE

Available as a one-bedroom configuration or as a two-bedroom (as illustrated) by adjoining with a Vista Suite.

1 BEDROOM: 919 SQ. FT. / 85 M²
INCLUDING VERANDA (220 SQ. FT. / 20 M²);
2 BEDROOM: 1,264 SQ. FT. / 117 M²
INCLUDING VERANDA (220 SQ. FT. / 20 M²)

- Large veranda with patio furniture and floor-to-ceiling glass doors; bedroom two has additional large picture window
- Living room with sitting area; bedroom two has additional sitting area
- Separate dining area and bar
- Twin beds or king-sized bed; bedroom two has additional twin beds or queen-sized bed
- Bathroom with double vanity, separate shower and full-sized whirlpool bath, plus a powder room; bedroom two has additional bathroom with full-sized bath
- Walk-in wardrobe(s) with personal safe
- Vanity table(s) with hair dryer
- Writing desk(s)
- Flat-screen TV(s) with Interactive Media Library
- Sound system with Bluetooth connectivity
- Espresso machine
- Unlimited Premium Wi-Fi



GRAND SUITE

Available as a one-bedroom configuration or as a two-bedroom (as illustrated) by adjoining with a Vista Suite.

1 BEDROOM: 941-1,090 SQ. FT. / 87-101 M²
INCLUDING VERANDA (103-116 SQ. FT. / 10-11 M²);
2 BEDROOM: 1,286-1,435 SQ. FT. / 119-133 M²
INCLUDING VERANDA (163-176 SQ. FT. / 16-17 M²)

- Large veranda with patio furniture and floor-to-ceiling glass doors; bedroom two has additional veranda
- Living room with sitting area; bedroom two has additional sitting area
- Separate dining area and bar
- Twin beds or king-sized bed; bedroom two has additional twin beds or queen-sized bed
- Bathroom with double vanity, separate shower and full-sized whirlpool bath, plus a powder room; bedroom two has additional bathroom with full-sized bath
- Walk-in wardrobe(s) with personal safe
- Vanity table(s) with hair dryer
- Writing desk(s)
- Flat-screen TV(s) with Interactive Media Library
- Sound system with Bluetooth connectivity
- Espresso machine
- Unlimited Premium Wi-Fi



ROYAL SUITE

Available as a one-bedroom configuration or as a two-bedroom (as illustrated) by adjoining with a Vista Suite.

1 BEDROOM: 967-1,007 SQ. FT. / 90-94 M²
INCLUDING VERANDA (110-116 SQ. FT. / 10-11 M²);
2 BEDROOM: 1,312-1,352 SQ. FT. / 122-126 M²
INCLUDING VERANDA (170-176 SQ. FT. / 16-17 M²)

- Large veranda with patio furniture and floor-to-ceiling glass doors; bedroom two has additional veranda
- Living room with sitting area; bedroom two has additional sitting area
- Separate dining area and bar
- Twin beds or king-sized bed; bedroom two has additional twin beds or queen-sized bed
- Bathroom with double vanity, separate shower and full-sized whirlpool bath, plus a powder room; bedroom two has additional bathroom with full-sized bath
- Walk-in wardrobe(s) with personal safe
- Vanity table(s) with hair dryer
- Writing desk(s)
- Flat-screen TV(s) with Interactive Media Library
- Sound system with Bluetooth connectivity
- Espresso machine
- Unlimited Premium Wi-Fi



SILVER SUITE

Silver Suites accommodate three guests.

653-701 SQ. FT. / 61-65 M²
INCLUDING VERANDA (110-123 SQ. FT. / 10-11 M²)

- Veranda with patio furniture and floor-to-ceiling glass doors
- Living room (with convertible sofa to accommodate an additional guest)
- Sitting area
- Separate dining area
- Twin beds or queen-sized bed
- Bathroom with double vanity, separate shower and full-sized whirlpool bath
- Walk-in wardrobe with personal safe
- Vanity table with hair dryer
- Writing desk
- Flat-screen TV(s) with Interactive Media Library
- Sound system with Bluetooth connectivity
- Espresso machine
- Unlimited Premium Wi-Fi



MEDALLION SUITE

Medallion Suites accommodate three guests.

521 SQ. FT. / 49 M²
INCLUDING VERANDA (81 SQ. FT. / 8 M²)

- Veranda with patio furniture and floor-to-ceiling glass doors
- Living room with sitting and dining area
- Twin beds or queen-sized bed
- Bathroom with double vanity, separate shower and full-sized whirlpool bath
- Walk-in wardrobe with personal safe
- Vanity table with hair dryer
- Writing desk
- Flat-screen TV with Interactive Media Library
- Sound system with Bluetooth connectivity
- Espresso machine
- Unlimited Premium Wi-Fi



DELUXE VERANDA SUITE SUPERIOR VERANDA SUITE CLASSIC VERANDA SUITE

Veranda Suites 605, 606, 640-645, 648, 649, 652, 653, 656 and 657 accommodate three guests. Deluxe Verandas offer preferred central location with identical accommodations to Classic and Superior Verandas.

345 SQ. FT. / 32 M²
INCLUDING VERANDA (60 SQ. FT. / 6 M²)

- Veranda with patio furniture and floor-to-ceiling glass doors
- Sitting area
- Twin beds or queen-sized bed
- Bathroom with double vanity, full-sized bath, separate shower
- Walk-in wardrobe with personal safe
- Vanity table with hair dryer
- Writing desk
- Flat-screen TV with Interactive Media Library
- Unlimited Standard Wi-Fi



VISTA SUITE

287 SQ. FT. / 27 M²

- Large picture window providing panoramic ocean views (Vista Suite)
- Sitting area
- Twin beds or queen-sized bed
- Bathroom with double vanity, full-sized bath, separate shower
- Walk-in wardrobe with personal safe
- Vanity table with hair dryer
- Writing desk
- Flat-screen TV with Interactive Media Library
- Unlimited Standard Wi-Fi

AMENITIES & FEATURES FOR ALL SUITES

- Butler service
- Refrigerator and bar setup stocked with your preferences
- Pillow menu
- Luxury bath amenities
- Plush bathrobe and slippers
- Umbrella
- Complimentary Wi-Fi for all suites
- Direct-dial telephone(s)
- Champagne on arrival



EXPLORE OUR DESTINATION VOYAGES

Use your smartphone camera to frame the QR Code (left) and tap the link that appears on the screen. You may need to download a QR reader app.

FOR RESERVATIONS* CONTACT YOUR TRAVEL ADVISOR OR SILVERSEA.



株式会社ビュート
043-273-7123
www.bute.co.jp

〒261-0023 千葉県千葉市美浜区中瀬1-3

幕張テクノガーデンB棟5階

総合旅行業務取扱管理者 村田 洋一

千葉県知事登録旅行業第2-981号

日本旅行業協会正会員 



*FOR GUESTS CURRENTLY ONBOARD CONTACT YOUR FUTURE CRUISE MANAGER

FOR FURTHER DETAILS ON AVAILABILITY AND FARES VISIT SILVERSEA.COM